

Lepre

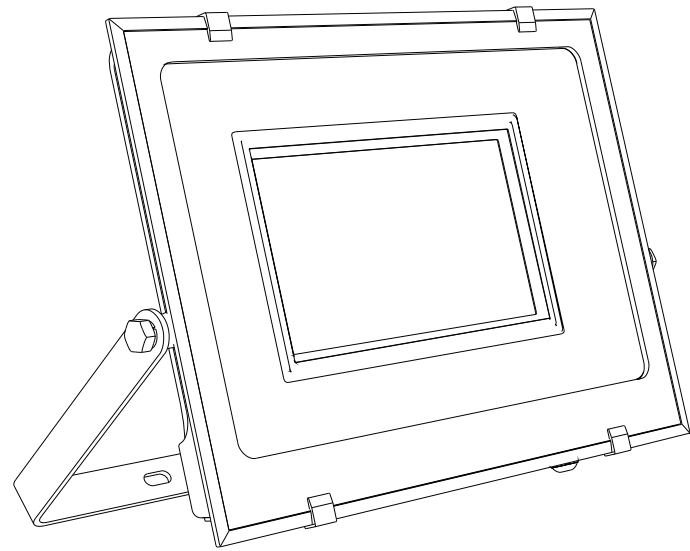

LED Flood Light User Guide

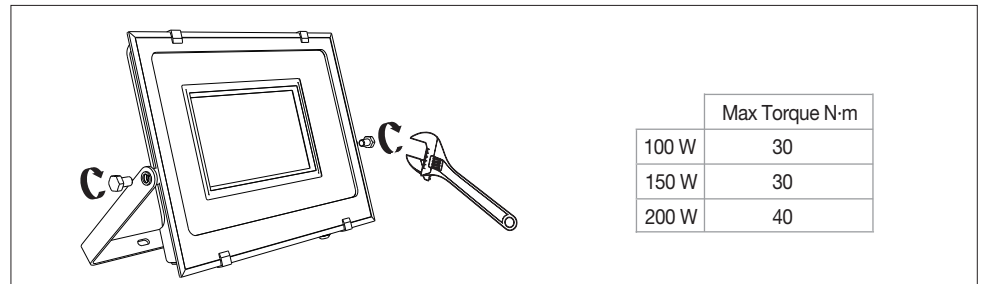
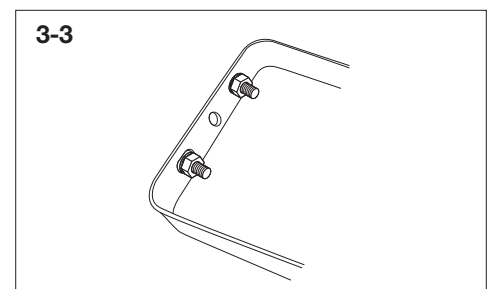
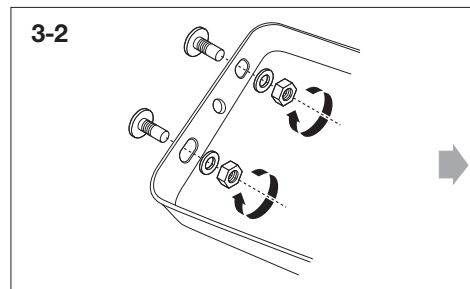
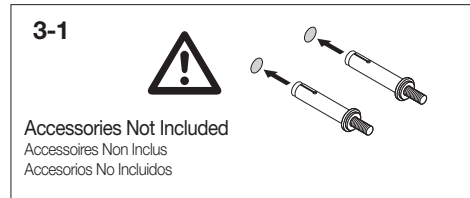
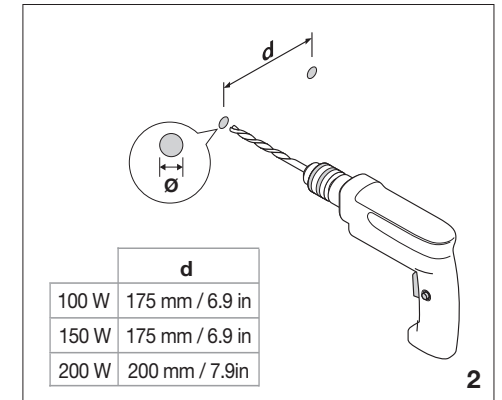
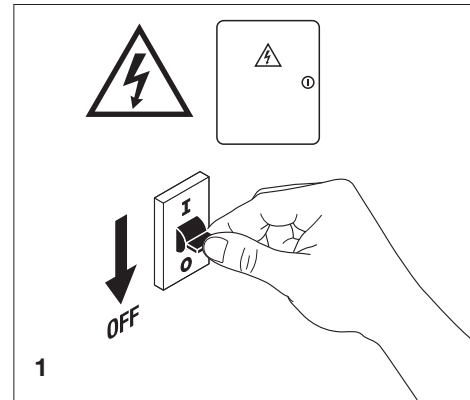

Model NO. / Modèle No. / N°de Modelo:

340017-DW-US 10000 lm

100 W, 110-130 Vac, 50/60 Hz, IP65, 5000K, 0.85 A, PF>0.9, 110°, CRI≥80, -20 °C ~ 40 °C / -4 °F ~ 104 °F

340018-DW-US 15000 lm

150 W, 110-130 Vac, 50/60 Hz, IP65, 5000K, 1.27 A, PF>0.9, 110°, CRI≥80, -20 °C ~ 40 °C / -4 °F ~ 104 °F

340019-DW-US 20000 lm

200 W, 110-130 Vac, 50/60 Hz, IP65, 5000K, 1.68 A, PF>0.9, 110°, CRI≥80, -20 °C ~ 40 °C / -4 °F ~ 104 °F

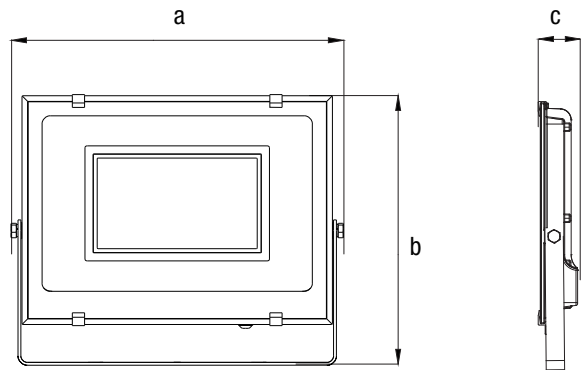

	a	b	c	g
100 W	269.5 mm / 10.6in	230 mm / 9.0 in	42 mm / 1.6 in	1300g
150 W	339.5 mm / 13.3in	291.7 mm / 11.5in	42 mm / 1.6 in	1800g
200 W	404 mm / 15.9in	331 mm / 13.0in	43.5 mm / 1.7 in	3100g

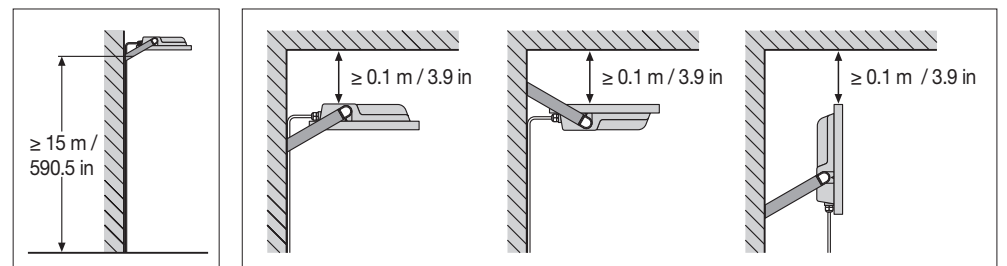
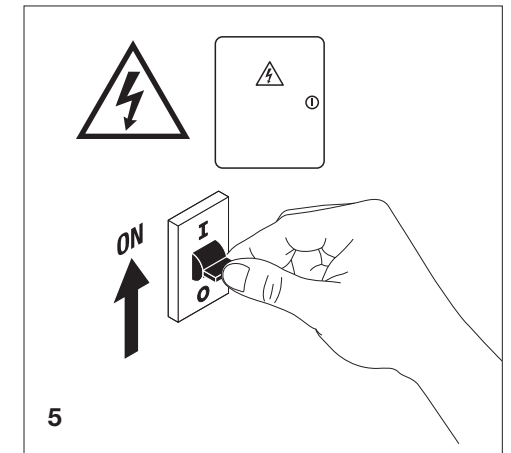
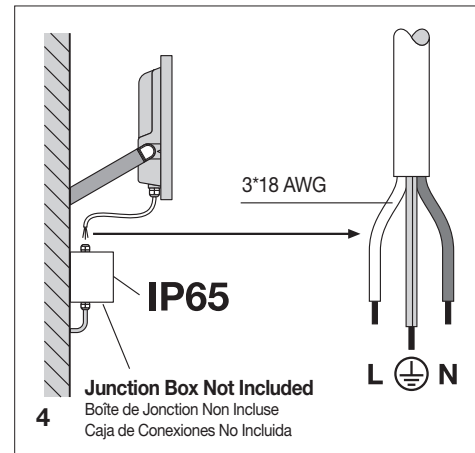
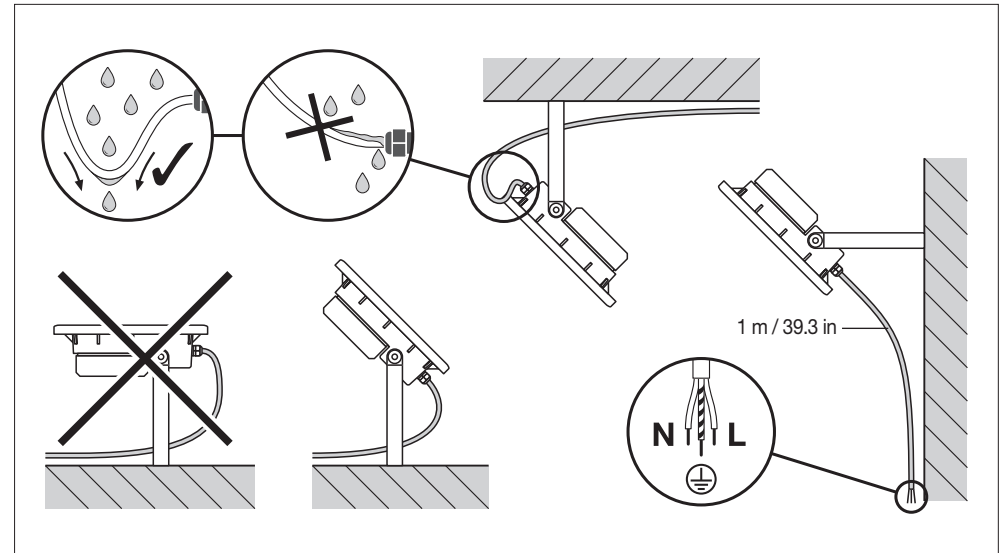

EN

THIS PRODUCT MUST BE INSTALLED IN ACCORDANCE WITH THE APPLICABLE INSTALLATION CODE BY A PERSON FAMILIAR WITH THE CONSTRUCTION AND OPERATION OF THE PRODUCT AND THE HAZARDS INVOLVED

1. This product is class I and must be earthed.
2. Please switch off mains supply before installation.
3. Ensure all seals are intact and operational after installation or maintenance.
4. Do not touch the light while in use or just after use to avoid being burnt.
5. Glass cover can break into small pieces.
6. The light source of this luminaire is not replaceable; when the light source reaches its end of life the whole luminaire shall be replaced.
7. The external flexible cable or cord of this luminaire cannot be replaced; if the cord is damaged, the luminaire shall be destroyed.
8. SUITABLE FOR WET LOCATIONS
9. SUITABLE FOR OPERATION IN AMBIENT NOT EXCEEDING 40°C

FR

CE PRODUIT DOIT ÊTRE INSTALLÉ SELON LE CODE D'INSTALLATION PERTINENT, PAR UNE PERSONNE QUI CONNAÎT BIEN LE PRODUIT ET SON FONCTIONNEMENT AINSI QUE LES RISQUES INHÉRENTS

1. Ce produit est de classe I et doit être mis à la terre.
2. Veuillez couper l'alimentation du secteur avant l'installation.
3. Il vous faut assurer que tous les joints sont intacts et opérationnels après l'installation ou la maintenance.
4. Ne touchez pas la lumière pendant l'utilisation ou juste après pour éviter de vous brûler.
5. Le couvercle en verre se brise en petits morceaux.
6. La source lumineuse de ce luminaire n'est pas remplaçable; lorsque la source lumineuse arrive en fin de vie, l'ensemble du luminaire doit être remplacé.
7. le câble ou cordon flexible externe de ce luminaire ne peut être remplacé ; si le cordon venait à être endommagé, le luminaire devrait être détruit.
8. CONVIENT AUX EMPLACEMENTS MOUILLÉS
9. PEUT ÊTRE UTILISÉ À UNE TEMPÉRATURE AMBIANTE N'EXCÉDANT PAS 40°C

ES

ESTE PRODUCTO DEBE SER INSTALADO DE ACUERDO CON EL CÓDIGO DE INSTALACIÓN APLICABLE POR UNA PERSONA FAMILIARIZADA CON LA CONSTRUCCIÓN Y FUNCIONAMIENTO DEL PRODUCTO Y LOS PELIGROS IMPLICADOS

1. Este producto es de clase I y debe estar conectado a tierra.
2. Por favor, apague la fuente de alimentación antes de la instalación.
3. Asegúrese de que todos los sellos estén intactos y operativos después de la instalación o el mantenimiento.
4. No toque la luz mientras esté en uso o justo después de usarla para evitar quemarse.
5. La cubierta de vidrio se rompe en pedazos pequeños.
6. La fuente de luz de esta luminaria no es reemplazable; Cuando la fuente de luz llegue al final de su vida útil, se reemplazará toda la luminaria.
7. el cable flexible externo o la cuerda de esta luminaria no se pueden reemplazar; si el cable está dañado, la luminaria se romperá.
8. ADECUADO PARA LUGARES HÚMEDOS.
9. ADECUADO PARA FUNCIONAMIENTO EN AMBIENTE NO SUPERIOR A 40°C.

This device complies with Part 15 of the FCC Rules. Operation is subject to the following two conditions: (1) this device may not cause harmful interference, and (2) this device must accept any interference received, including interference that may cause undesired operation.

Changes or modifications to this unit not expressly approved by the party responsible for compliance could void the user's authority to operate the equipment.

NOTE: This equipment has been tested and found to comply with the limits for a Class B digital device, pursuant to Part 15 of the FCC Rules. These limits are designed to provide reasonable protection against harmful interference in a residential installation. This equipment generates, uses and can radiate radio frequency energy and, if not installed and used in accordance with the instructions, may cause harmful interference to radio communications. However, there is no guarantee that interference will not occur in a particular installation. If this equipment does cause harmful interference to radio or television reception, which can be determined by turning the equipment off and on, the user is encouraged to try to correct the interference by one or more of the following measures:

- Reorient or relocate the receiving antenna.
- Increase the separation between the equipment and receiver.
- Connect the equipment into an outlet on a circuit different from that to which the receiver is connected.
- Consult the dealer or an experienced radio/ TV technician for help.



Conforms to UL Std. 1598

Certified to CSA Std. C22.2#250.0

LEPRO INNOVATION INC

3651 Lindell Road Suite D1048, Las Vegas, NV 89103, USA
www.lepro.com +1 866-287-2558 cs@lepro.com

Le Ming Trading Inc.

801-6081 No. 3 Rd. Richmond, BC, V6Y 2B2, CA
www.lepro.ca +1 833-433-1453 cs@lepro.ca Made in China Fabriqué en Chine